



27

# Park Lane

4 2 X 1 4 - 2 & 3 B E D R O O M

ALSO AVAILABLE TO RESIDENTIAL SPECIFICATION



Park Lane has continued to evolve over the years and push the boundaries of design. This years' new model is no exception and will appeal to anyone with a discerning eye. The black gloss kitchen looks rich and inviting coupled with the walnut wood which adds warmth throughout. The integrated cooker, microwave and fridge freezer are kept separate from the main kitchen which creates extensive space for storage, food preparation and a breakfast bar.

Both the 2 and 3 bedroom models have a utility room which houses a washer/dryer that comes as standard with the Park Lane. This has been incorporated without compromising on the space or layout of this very popular holiday home.

The new sofa and armchairs are luxurious and you can sink into them and admire the vista through the large patio doors. On colder evenings you can cosy up and put on your Optimist fire to create a really relaxing atmosphere.

[www.pembertonlh.co.uk](http://www.pembertonlh.co.uk)

Park Lane  
the first choice  
for your new home



# Park Lane

4 2 X 1 4 - 2 & 3 B E D R O O M

ALSO AVAILABLE TO RESIDENTIAL SPECIFICATION





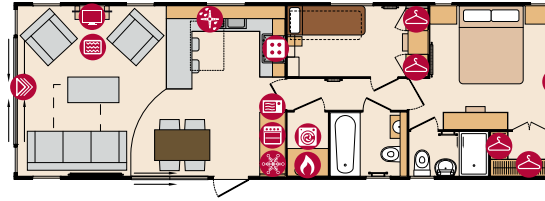

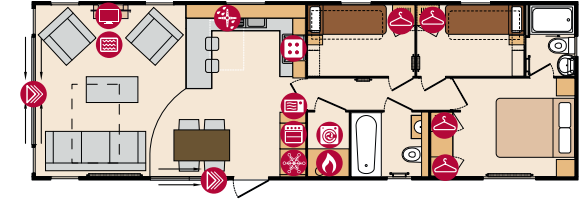

42 x 14 - 2 Bedroom



42 x 14 - 3 Bedroom



### STANDARD FEATURE HIGHLIGHTS

-  TV Space
-  Microwave
-  Wardrobe
-  Electric Fire
-  Washer/Dryer
-  Patio Doors
-  Cooker
-  Dishwasher
-  Boiler
-  Hob
-  Fridge-Freezer

- PVC-U double glazing with patio doors to front and side elevation, patio doors in main bedroom in 2 bed version.
- Gas combi central heating and thermostatic radiator valves
- Fibreglass insulation: 150mm - roof; 60mm - walls and underfloor
- Vaulted ceilings throughout with a minimum ceiling height of 2.2m (7ft 4")
- Log effect electric fire with remote control
- TV bracket and ariel socket in lounge
- Thermostatic mixer valve to en-suite shower and bath
- 5 burner hob with externally vented extractor hood
- High level cooker with separate oven and grill
- Integrated Fridge/Freezer, microwave, dishwasher
- Washer dryer/utility room
- Large recycle bin in kitchen cupboard
- Bathroom with bath
- Skylight in kitchen
- Luxurious lounge suite (incorporating sofa bed)
- Ottoman
- Twin bar stools
- 5ft wide divan bed in master bedroom (2 bed models)
- Walk-in wardrobe to master bedroom (2 bed models)
- Duvet covers, pillowcases, cushions and throws
- Multi-outlet TV aerial booster
- Pitched roof clad in pan tile effect plastisol coated galvanised steel
- Fire extinguisher, smoke detector and carbon monoxide detector
- External electric socket
- Twin axle pre-galvanised steel chassis with detachable tow bar

For further details see Feature Checklist on pages 69-70

### OPTIONS AVAILABLE TO ORDER

- Residential Specification to BS3632 available in all cladding types
- Alternative electric heating in lieu of gas combi central heating
- Windows in lieu of patio doors - not available in Residential Specification
- Leather lounge suite (without sofa bed)
- Occasional/accents Chair
- Ivory kitchen doors
- Park Lane Lodge available in timber, vinyl and Canexel cladding
- Baths Changed to showers
- Stowaway occasional bed available as an optional accessory
- Alternative size single beds available (for example 2ft 6", 3ft and 3ft 6")

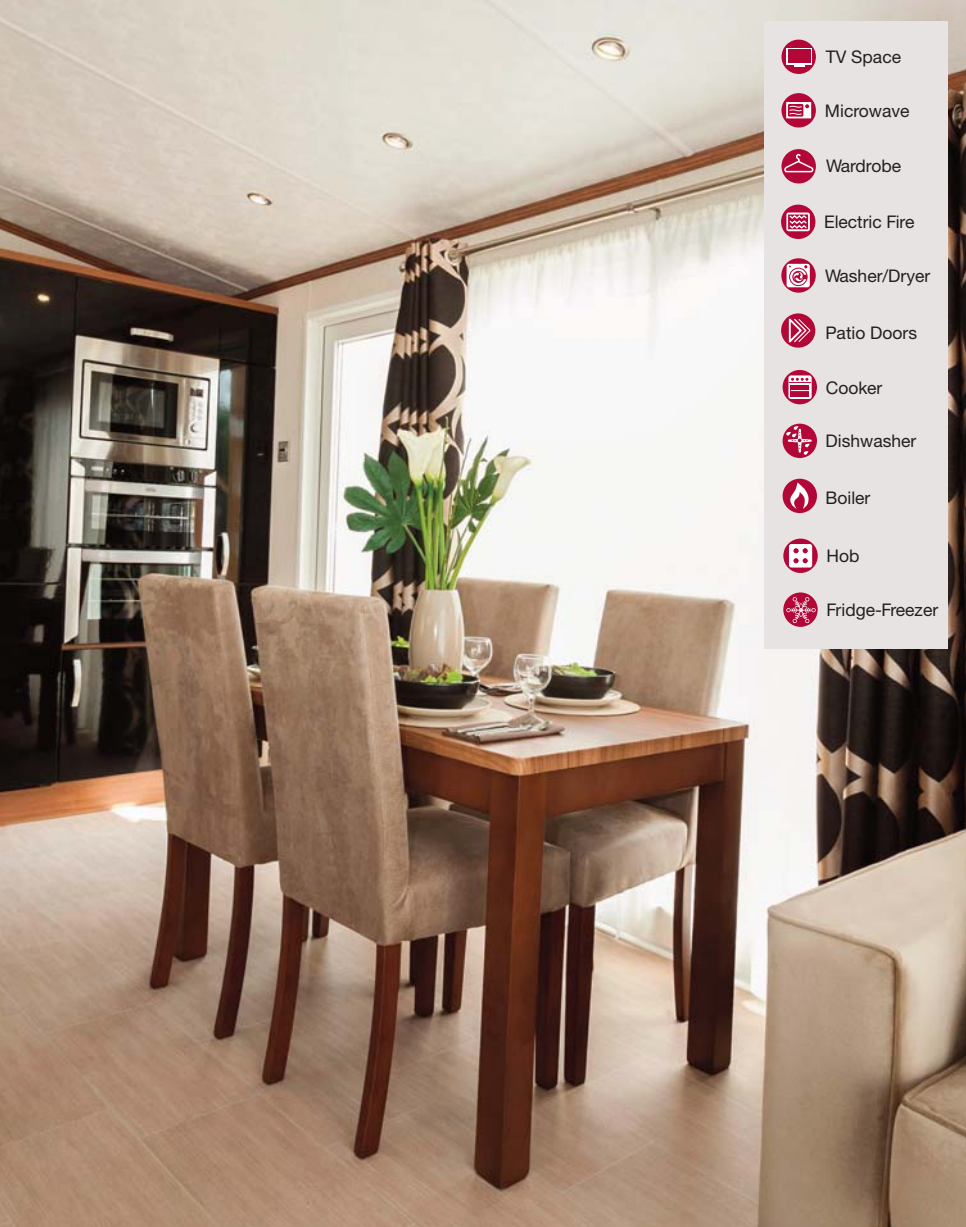



# Park Lane

4 2 X 1 4 - 2 & 3 B E D R O O M

ALSO AVAILABLE TO RESIDENTIAL SPECIFICATION



In the bedrooms Boutique Hotel chic meets comfort and glamour. Copper tones are accentuated with charcoal and black to create a smart, contemporary sleeping area. A patio door to the master bedroom means you can laze in bed on a warm day with the sun streaming into the room. Stylish dresser chairs are a new addition this year.

The Park Lane will certainly impress and inspire you and your family and friends.